

## Standard Reamer

Date: _____	PO #: _____
Distributor: _____	Location: _____
Contact: _____	Phone: _____
Email: _____	Fax: _____
# of Pieces: _____	Hardness: _____
Material : _____	

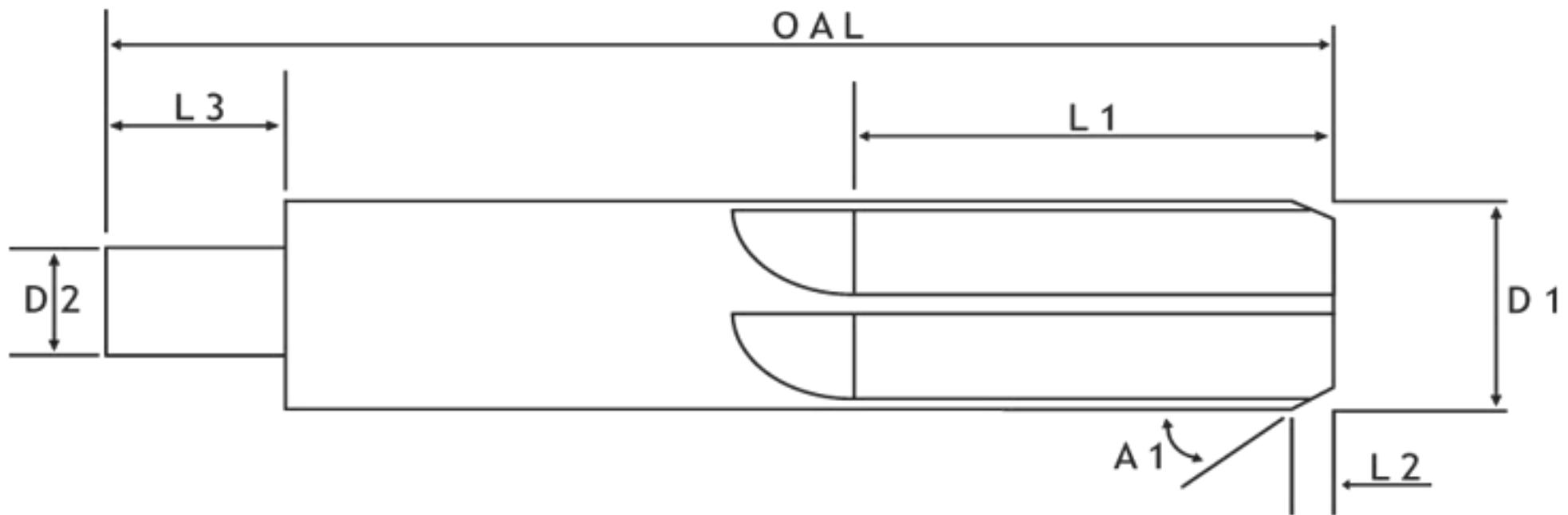

\*\* CHECK HERE TO SELECT SPECIAL SHANK, THEN SELECT SHANK DESIGNATION BELOW \*\*

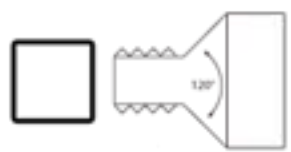

Threaded UNF-2A

- 1/4-28
- 5/16-24
- 3/8-24



Zephyr

- 1/4-28
- 10-32



Quick Change



Tri - Flat

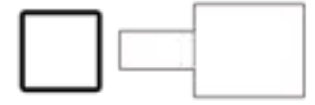

Reduced Shank

Tool Specifications: Modify Standard Tool  Yes  No EDP# \_\_\_\_\_

Shank Design: \_\_\_\_\_ OAL: \_\_\_\_\_

Coating: \_\_\_\_\_ A1: \_\_\_\_\_ A2: \_\_\_\_\_

D1: \_\_\_\_\_ D2: \_\_\_\_\_ D3: \_\_\_\_\_ D4: \_\_\_\_\_

L1: \_\_\_\_\_ L2: \_\_\_\_\_ L3: \_\_\_\_\_ L4: \_\_\_\_\_

Special Instructions: \_\_\_\_\_

Standard Tolerances used unless otherwise specified

- .x = ± .1
- .xx = ± .01
- .xxx = ± .005
- .xxxx = ± .0005
- Fractions = ± 1/64"
- Angular = ± 3°